

## DHU-100 / DHU-135 TOUCH II

### HIGH SPIN | SOFT-MOUNT | WASHER EXTRACTOR



#### TOUCH II

User friendly and totally programmable control.  
7" color touch screen.  
Create an infinite number of programs (29 pre-set and time-of-day promotions).  
Import and export programs, statistics, and software updates via USB.  
8 programmable signals for automatic liquid dosing.  
Play videos.  
37 available languages.  
Wet Cleaning ready.



#### G FACTOR

Up to **450G** (soft-mount, high spin washers)



#### EFFICIENCY

Intelligent consumption  
Optimal loading  
Water Recovery tanks ready: ECOTANK  
Low water consumption



#### VERSATILITY

Make to order: customization  
OPL < > COIN  
Electric < > Hot water  
Drain valve < > Pump  
Wet cleaning features



#### CONNECTIVITY

Remote technical service  
Management of laundries: OPL and COIN  
Remote payment



#### ERGONOMICS

Biggest door diameters: Ø22"  
Easy opening/closing system for door lock.



#### MAINTENANCE

Hinged panel: easy access to parts  
Equivalent parts for all models.  
Technical menu: traceability, error diagnosis.



#### OTHERS

Grey skinplate outer casing  
3 standard water inlets.  
Drum and tub in stainless steel AISI 304  
Detergent dispenser with 4 compartments  
Electronic control of imbalance with frequency control  
LOADING AID feature: water and rotation control  
ETL, CE, and WRAS certified product.



#### OPTIONS

- Stainless steel AISI 304 outer casing
- Stainless steel AISI 304 front panel
- Double drain
- Normally closed valve
- Water RE-CYCLE system.
- Tilting options: frontal or double tilt
- Auto Weight: automatic weighing sensor system.
- Kit with 6 extra dosing signals
- Printer
- DomusConnect communication kit
- Reversible door opening
- Steam kit to transform an E or HW heated machine into steam version
- Plinth to level all machines from top
- Plinth to align loading height (door base at 33.5")
- Maritime voltage for electric models: 440V III 50/60 Hz No neutral
- Coin/token kit
- Delayed door opening in case of power outage

# TECHNICAL DATA

# UNIT.

# DHU - 100

# DHU - 135

## DRUM

Load capacity 1/9 - 1/10	lbs	100	135
Volume	cu ft	16	21
Diameter	in	36.14	41.25
Depth	in	28.44	27.00

## GENERAL DATA

Wash speed / Spin speed	rpm	42.5/934	38/875
G Force	-	450	450
Maximum force transmitted	kN	11.23 ±3.15	12.95 ±4.2
Dynamic force frequency	Hz	14.1	7.58
Noise level	dB	< 70	< 70
Self-service version	-	-	-
Double drain	-	Opt.	Opt.
Weighing system	-	Opt.	Opt.

## DOOR

Height door centre / Height door base	in	46.85 / 32.67	46.85 / 32.67
Diameter	in	22	22

## POWER

Motor	Hp	10	14.75
Heating (electric heating model)	kW	28.8	36
Maximum power (electric heating model)	kW	31.3	40
Maximum power (steam and hot water model)	kW	7.5	11

## CONNECTIONS

		ELECTRIC	HOT WATER	STEAM	ELECTRIC	HOT WATER	STEAM
208-240V / 50-60 Hz / 3	FLA (Amps)	80 A	32 A	32 A	100 A	40A	40 A
440V / 50-60 Hz / 3	FLA (Amps)	63 A	20 A	20 A	63 A	32 A	32 A
Steam inlet (Steam mod.)	in		3/4"			3/4"	
Maximum steam consumption (Steam, mod.)	lbs/h		42			46.3	
Water inlet	in		1"			1"	
Grid pressure	kg/cm2		2-4			2-4	
Maximum water consumption *	gal/h		125			168.22	
Drain	in		3"			3"	
Drainage capacity	gal/min		52.8			52.8	

## DIMENSIONS / DIMENSIONS WITH PACKAGING

Width / Width	in	56.18 / 65.00	56.18 / 65.00
Depth / Depth	in	56.18 / 65.00	56.18 / 65.00
Height / Height	in	75.20 / 78.00	75.20 / 78.00
Net weight / Gross weight	lbs	2976/ 3130	3086/ 3351
Gross volume (with packaging)	cu ft	169.20	169.20

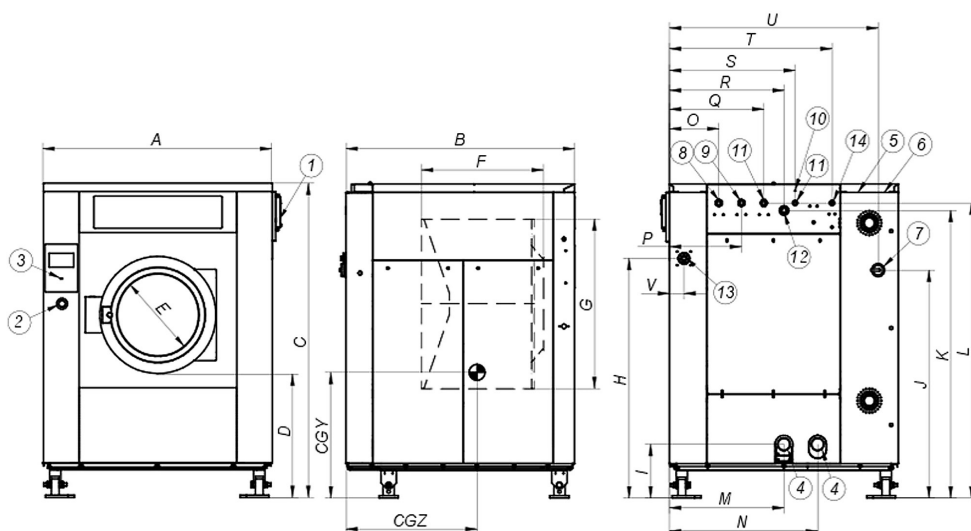

- ① Soap dispenser.
- ② Emergency stop.
- ③ USB port.
- ④ Drain.
- ⑤ Electrical connection to liquid soap pumps.
- ⑥ Electrical connection.
- ⑦ Main switch.
- ⑧ Auxiliary water inlet.
- ⑨ Hot water inlet.
- ⑩ Earth connection.
- ⑪ Cold water inlet.
- ⑫ Water overflow.
- ⑬ Connection for liquid soap.
- ⑭ Steam connection.

DIMENSIONS (IN)	A	B	C	D	E	F	G	H	I	J	K	L	M	N	O	P	Q	R	S	T	U	V	CGY	CGZ
DHU-100	56.18	56.14	76.57	29.41	22.05	29.92	36.22	58.43	13.11	55.55	70.08	71.93	28.11	36.38	12.17	17.68	23.19	28.15	30.87	39.92	51.26	3.66	24.61	37.13
DHU-135	56.18	56.14	76.57	29.41	22.05	29.92	41.34	58.43	13.11	55.55	70.08	71.93	28.11	36.38	12.17	17.68	23.19	28.15	30.87	39.92	51.26	3.66	24.61	37.13